



Data sheet aseptic tank bottom valve SBTV 1  
Rev.04/09 Page 1 of 3

## SBTV – ASEPTIC TANK BOTTOM VALVE

The SBTV sterile valves with manual or pneumatic actuator are available in two different versions:

1. With fixed flange (flush wall) to weld directly to the tank bottom,
2. With removable body by means of flange and its counter flange. (TKC)

The clean design of the valve, guarantees its full drainability, avoid possible product stagnation and "dead leg" this permitting using the valves in clean process applications. Available in manual or Pneumatic

### Technical Data

Size:  $\frac{3}{4}$ " to 3"  
Diaphragm: Silopren LSR 2670, TFM 1600 PTFE  
Connection: Butt Weld, Tri Clamp (1)  
(1) Additional connections on request

#### Operating conditions:

Max Working Pressure: up to 6 barg  
Max Working Temperature:  $-10^{\circ}\text{C}$  to  $150^{\circ}\text{C}$   
Medium: Fluids group 1 and 2

Design temperature valve body:  $-80^{\circ}\text{C}$  to  $200^{\circ}\text{C}$  ( $-112^{\circ}\text{F}$  to  $392^{\circ}\text{F}$ )  
Design pressure, valve body: -1 bar to 10 bar (-14,5 psi to 101,5 psi)

#### Material:

Welding flange: ASTM A 479 / ASTM A 182 - 316L

#### Surface Finish:

Product contact surface finished:  $R_a \leq 0.6 \mu\text{m}$   
External surface finish: Mirror mechanical polish  
Other surface finish are available upon request

#### Documentation:

The following validation documentations are available:

- welding guideline
- 3.1B certificate on wetted parts
- FDA certificate of conformity for Silicone and TFM diaphragms
- ATEX 94/9/CE certificate
- Product contact Surface roughness

#### Marking:

Material, Heat No., order number, manufacturing date, and part number for full traceability

#### Final inspection

- roughness inspection on product contact surfaces
- 100% visual inspection on weldings
- 100% pressure tested & tightness





Data sheet aseptic tank bottom valve SBTV 1  
Rev.04/09 Page 2 of 3

## WELDED BODY

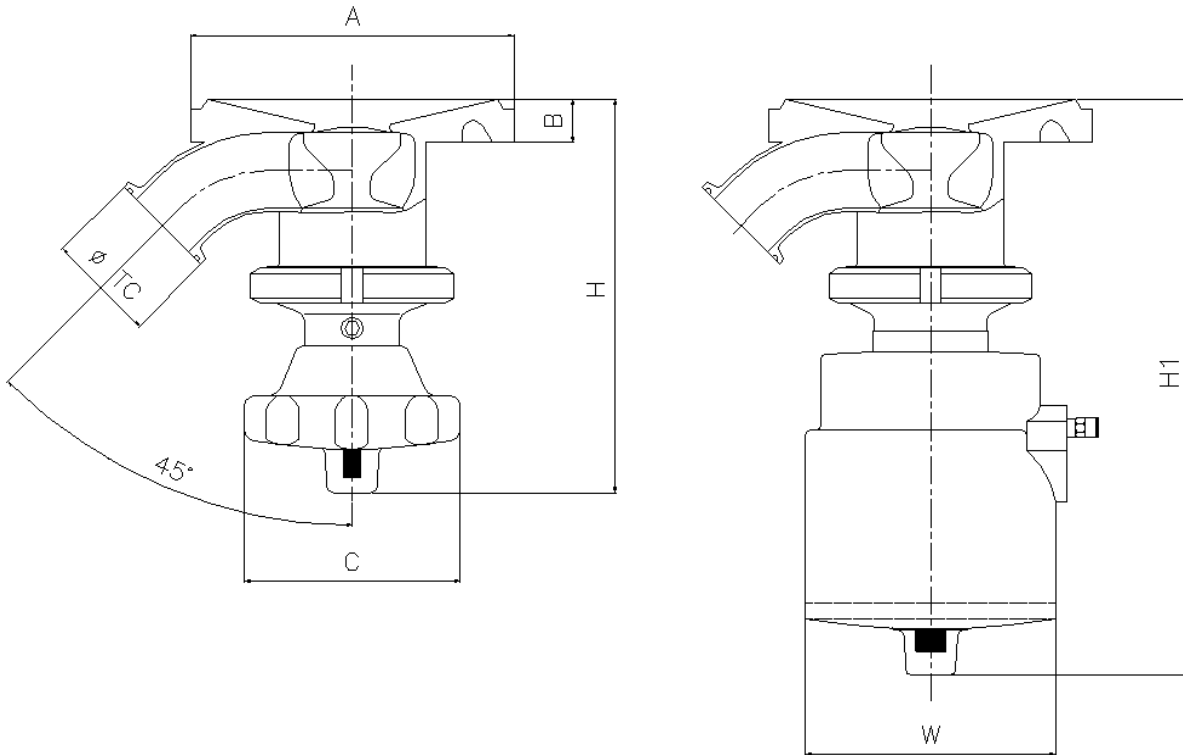

Dimensions table

Part No.	INCH	DN	ØTC	ID	A	B	C	H	W	H1
SBTV-S/TC1"	1"	25	50,4	22,1	100	15	100	165	85	230
SBTV-S/TC1"1/2	1" 1/2	40	50,4	34,8	150	20	100	180	116	270
SBTV-S/TC2"	2"	50	64	47,5	180	20	100	200	140	330
SBTV-S/TC3"	3"	80	90	72,9	200	35	100	270	140	350
SBTV-S/TC4"	4"	100	118,8	97,6	Available on request only					

Customised or special applications are available on request :

CSKBIO

Internet: [www.cskbio.com](http://www.cskbio.com) Email: [sales@cskbio.com](mailto:sales@cskbio.com)



## TKC - DISMOUNTABLE BODY

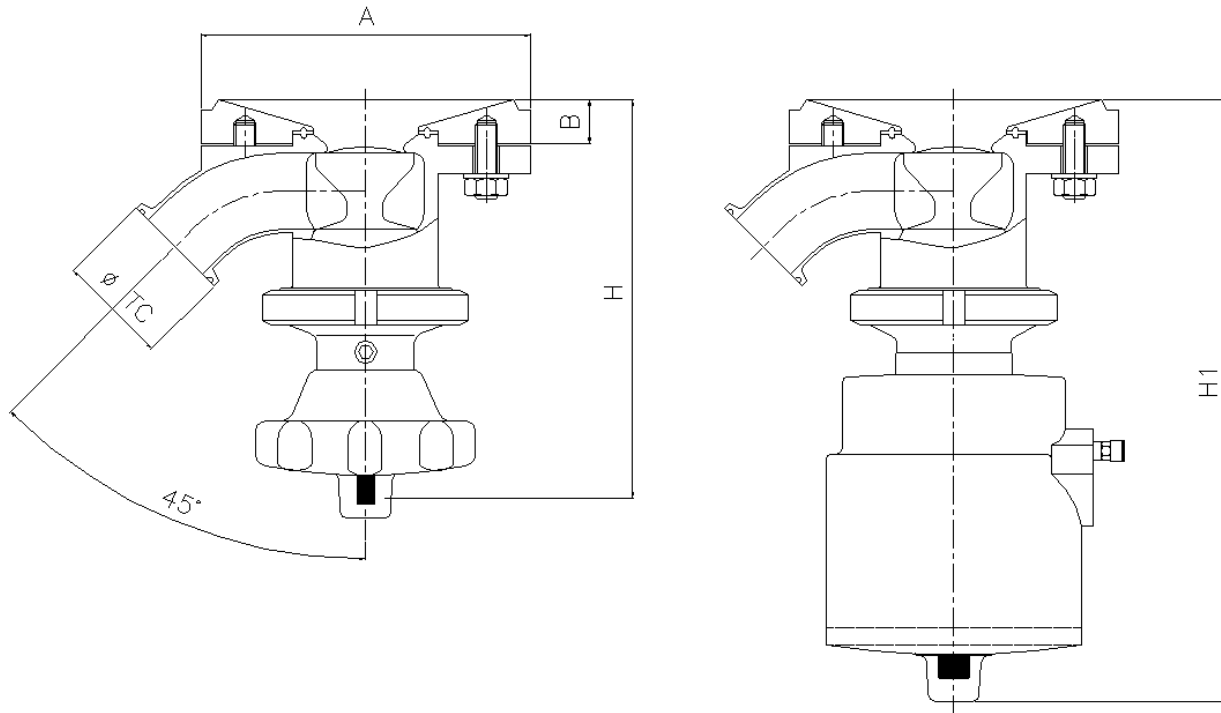

Dimensions table

Part No.	INCH	DN	ØTC	ID	A	B	H	H1
SBTV-FL/TC1"	1"	25	50,4	22,1	100	15	175	240
SBTV-FL/TC1"1/2	1" 1/2	40	50,4	34,8	150	20	190	285
SBTV-FL/TC2"	2"	50	64	47,5	180	20	205	345
SBTV-FL/TC3"	3"	80	90	72,9	200	35	275	370
SBTV-FL/TC4"	4"	100	118,8	97,6	Available on request only			

Customised or special applications are available on request :

- TK-Connection welding plate with customised radius or different thickness, special adaptor plates are available
- TFM 1600 PTFE bellow diaphragm for high viscosity products
- 45° Outlet port butt weld
- Stainless steel handle / pneumatic actuator
- Adjustable flow regulator
- Mechanical / inductive control box



Additional information and more at: [sales@cskbio.com](mailto:sales@cskbio.com)  
The specifications or design are subject to change without prior notice.