



TKCI – TANK CONNECTION INLINE

The TKCI is manufactured to ASTM A269 / 270 Standard this hygienic component may be used with clamp ends or orbital welded onto a piping system in order to avoid deadleg associated with installation of instrumentation. It may be also used in the installation and can be connected to any TC Clamp equipment or sealed with a standard blind cap when not in use

Advantages:

- Eliminate deadleg
- No product entrapment
- Flexible, fast and easy to adjust different equipment
- No air pockets during sterilisation
- Customized for your needs

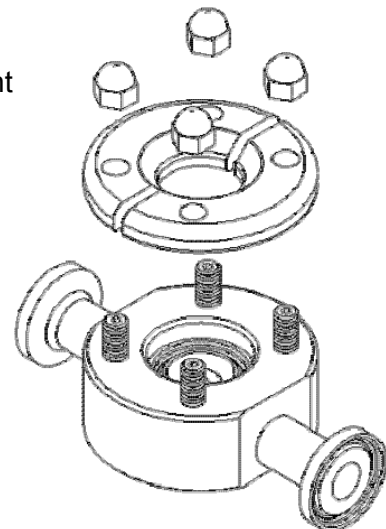
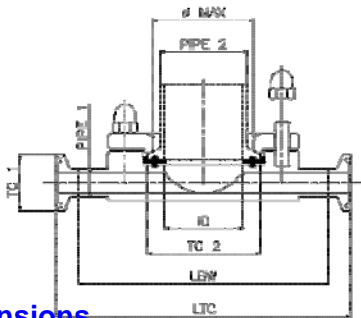

Dimensions

PART NUMBER	TC 1	Tube 1	TC 2	Pipe 2	ID	φ max	L TC	L BW	bolts
TKCI 1/2" x 3/4"	25.0	12.7 x 1.65	25.0	19.05 x 1.65	15.75	20.0	101.6	101.6	4 x M6
TKCI 1/2" x 1 1/2"	25.0	12.7 x 1.65	50.4	38.1 x 1.65	34.8	45.0	127.0	127.0	4 x M6
TKCI 3/4" x 3/4"	25.0	19.05 x 1.65	25.0	19.05 x 1.65	15.75	20.0	101.6	101.6	4 x M6
TKCI 3/4" x 1 1/2"	25.0	19.05 x 1.65	50.4	38.1 x 1.65	34.8	45.0	127.0	127.0	4 x M6
TKCI 1" x 1 1/2"	50.4	25.4 x 1.65	50.4	38.1 x 1.65	34.8	45.0	127.0	127.0	4 x M8
TKCI 1 1/2" x 1 1/2"	50.4	38.1 x 1.65	50.4	38.1 x 1.65	34.8	45.0	127.0	127.0	4 x M8
TKCI 1 1/2" x 2"	50.4	38.1 x 1.65	64.0	50.8 x 1.65	47.5	57.0	139.7	139.7	4 x M8
TKCI 2" x 2"	64.0	50.8 x 1.65	64.0	50.8 x 1.65	47.5	57.0	139.7	139.7	4 x M8

Maximum Operating conditions:

Design Pressure: -1bar to 7 barg (-14.5 psi to 101.5 psi)

Design temperature: -80°C to 200°C (-112°F to 392°F)

Material :

Welding flange: ASTM A 479 / ASTM A 182 – 316L

Locking ring: ASTM A 479 / ASTM A 182 – 316L

Bolts: ASTM A 193 B8 – 304

Nuts: ASTM A 194 8-304

Surface Finish:

Product contact surface finish: Ra ≤0.6 μm

Marking:

Material, heat and part No. for full lot traceability

Additional information and more at: sales@cskbio.com

The specifications or design are subject to change without prior notice.

