

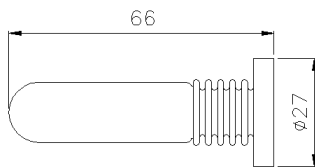

## SAMPLE VALVE $\phi$ 25mm INGOLD MOUNTED

This valve has been designed for sterile sampling from any type of vessel; mounted on an INGOLD the special configuration assures effective cleaning (CIP) and sterilization (with saturated steam) of product contact surface of valve and the sealing plug with the valve in closed position. Once installed; the sealing plug shuts off flush with the inlet port connection that guaranties zero deadleg, and real representative sample of the product.

The Ingold® sample valve is a special version adapted to the  $\phi$ 25mm ports, typically used on bio-reactors in the pharmaceutical and biotechnology industries, available with 30mm as standard length. Additional lengths 40 and 52mm available on request.



Machined Bellow Diaphragm



Ingold sample valve and with CIP / SIP port TC 1/2 ".

### Technical Data

**Installation:** the valve is inserted into an Ingold®  $\phi$ 25mm port and screwed into place. make sure o-ring and seals are in place and that the valve sits correctly in the port.

**Operating conditions:**

Maximum working pressure: Depend of choice of valve head  
Temperature range: Up to 130°C

**Material :**

valve body: stainless steel AISI 316L (1.4404)  
certificate EN 10204-3.1  
ring nut stainless steel AISI 304, o-ring in Viton as standard, EPDM or Silicone on request

**Connections :**

Sample port / CIP-SIP port connections standard 1/2" clamp,

**Surface finish :**

Wetted surface finish with  $Ra \leq 0,6 \mu m$  or better  
Electropolish inside –outside available on request

**Valve head available /Options :**

Manually actuated with thermoplastic handwheel  
Manual on-off toggle lever  
Manual safety spring return toggle lever  
Pneumatically actuated (spring return-air to open)

**Bellow diaphragm**

Diaphragm are machined from **TFM™ 1600 PTFE** bar, (Poly-Tetra-Fluor-Ethylene from Dyneon™- 3M)

### Documentation & Certificates

On request, we can supply the following validation documentation :

- EN 10204 3.1 material certificate
- Inside surfaces Ra Roughness certificates
- FDA certificate of conformity CFR title 21, paragraph 177.2600 for Silicone and paragraph 177.1550 for TFM 1600 PTFE
- U.S.Pharmacopoeia Class VI
- Specifications certificate of conformity
- ISO 9001 certificate
- ATEX 94/9/CE certificate

